

FOR LEASE

17171 Southpark Center

Strongsville, OH 44136



Demographic Snapshot *(2021 Estimated)*

	1 Mile	3 Miles	5 Miles
Population	4,658	54,512	138,228
Households	2,131	22,350	56,793
Median HH Inc	\$68,903	\$85,068	\$76,717
Average HH Inc	\$88,688	\$109,110	\$96,688
Daytime Pop	5,999	24,765	58,669

[View in Google Maps](#)

PROPERTY OVERVIEW

- Former Office Max available
- Conveniently located at I-71 and Royalton Road in Strongsville, 15 miles southwest of Downtown Cleveland
- Building on the pad of South Park Mall, the dominant retail shopping center on the Westside of Cleveland
- 23,600-28,000 SF available



The information submitted herein is not guaranteed. Although obtained from reliable resources, it is subject to errors, omissions, prior sale and withdrawal from the market without notice. Broker has made no investigation and makes no representation of the property.

Tony Visconsi

216.861.5349

tonyvisconsi@hannacre.com

FOR LEASE

17171 Southpark Center

Strongsville, OH 44136



The information submitted herein is not guaranteed. Although obtained from reliable resources, it is subject to errors, omissions, prior sale and withdrawal from the market without notice. Broker has made no investigation and makes no representation of the property.

Tony Visconsi

216.861.5349

tonyvisconsi@hannacre.com

FOR LEASE

17171 Southpark Center

Strongsville, OH 44136

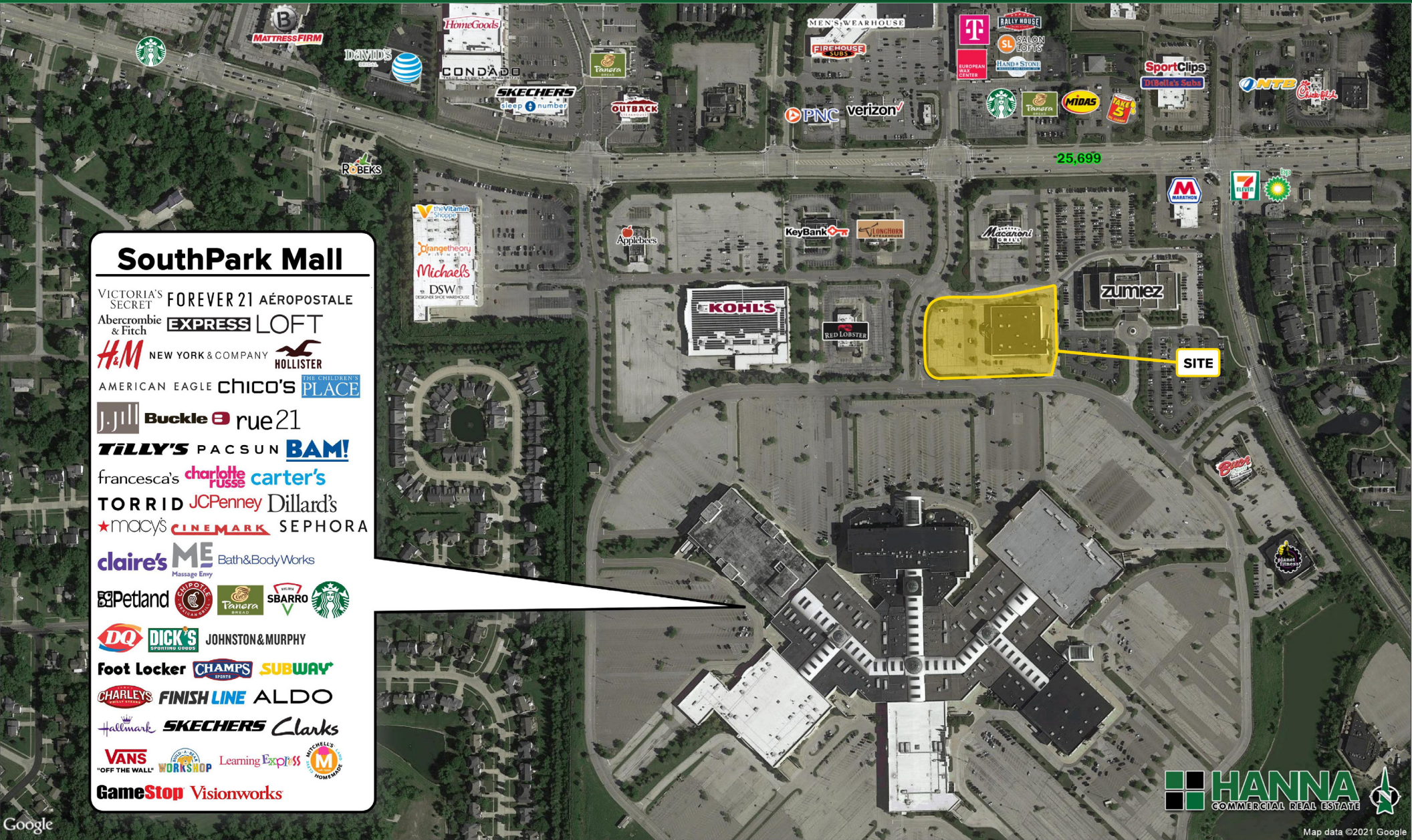

SouthPark Mall

VICTORIA'S SECRET FOREVER 21 AÉROPOSTALE
 Abercrombie & Fitch EXPRESS LOFT
 H&M NEW YORK & COMPANY HOLLISTER
 AMERICAN EAGLE chico's THE CHILDREN'S PLACE
 J.Jill Buckle B rue 21
 TILLY'S PACSUN BAM!
 francesca's charlotte russe carter's
 TORRID JCPenney Dillard's
 macys CINEMARK SEPHORA
 claire's ME Bath & Body Works
 Petland
 DQ DICK'S SPORTING GOODS JOHNSTON & MURPHY
 Foot Locker CHAMPS SUBWAY
 CHARLEY'S FINISH LINE ALDO
 Hallmark SKECHERS Clarks
 VANS "OFF THE WALL" WORKSHOP Learning Express MICHELLE'S HOMEWARES
 GameStop Visionworks



Google

Map data ©2021 Google



The information submitted herein is not guaranteed. Although obtained from reliable resources, it is subject to errors, omissions, prior sale and withdrawal from the market without notice. Broker has made no investigation and makes no representation of the property.

Tony Visconsi
 216.861.5349
 tonyvisconsi@hannacre.com

FOR LEASE

17171 Southpark Center

Strongsville, OH 44136



Strongsville, Ohio

Staples Plaza
STAPLES
Pizza

Greens of Strongsville
heinen's
FRIDAYS
Third Federal
TARGET
TJ-maxx
PetPeople
FAMOUS footwear
OLD NAVY
DOLLAR TREE
SALLY BEAUTY

The Plaza at Southpark
COSTCO WHOLESALE
BED BATH & BEYOND
petco
ULTA
LABOY
BEST BUY
five BEEW
Chick-fil-A
DiBella's Subs
rosewood GRILL

Westwood Commons
20,978 vpd
HOT WINGS
HOT WINGS
M
square

Royalton Collection
HomeGoods
tropical CAFE
OUTBACK STEAKHOUSES
City BARBELLUE

Great Escape Plaza
the great escape
FIREHOUSE SUBS
PNC
M
STARBUCKS

95,125 vpd

18,495 vpd
BUICK
GMC
Advanced Auto Parts

HOBBY LOBBY
ALDI
Malley's CHOCOLATES
OHIO SAVINGS
FIRST FEDERAL BANK
DUNKIN' DONUTS

25,699 vpd
M
bpc

23,606 vpd
Car's
us bank
PENN STATION
MCDONALD'S
NAPA
RITE AID

Strongsville Pointe
Dollar Bank
TACO BELL
POSTAL PARKS

SouthPark MALL
Dillard's
JCPenney
macy's
LONGHORN
DICK'S SPORTING GOODS
KOHL'S
CINEMARK
RED LOBSTER
ROMANO'S MACARONI GRILL
Duck at SEVVO
Applebee's
H&M
planet fitness
Cleveland Clinic Family Health and Surgery Center, Strongsville
KeyBank

Strongsville Towne Centre
PLATO'S FIVE GUYS
BURGER & FRIES
BIG LOTS!
BRUEGGER'S BAGELS
CLOTHES MENTOR
UNITED STATES POSTAL SERVICE
PNC

The Commons at Southpark
Michaels
CORELIFE
the Vitamin Shoppe
Orangetheory
spavia
DSW
DESIGNER SHOE WAREHOUSE
BROWN ACADEMY INSTITUTE

23,691 vpd

63,277 vpd

HANNA
COMMERCIAL REAL ESTATE

The information submitted herein is not guaranteed. Although obtained from reliable resources, it is subject to errors, omissions, prior sale and withdrawal from the market without notice. Broker has made no investigation and makes no representation of the property.

Tony Visconsi
216.861.5349
tonyvisconsi@hannacre.com

FOR LEASE

17171 Southpark Center

Strongsville, OH 44136

STORE #6534 - STRONGVILLE, OH

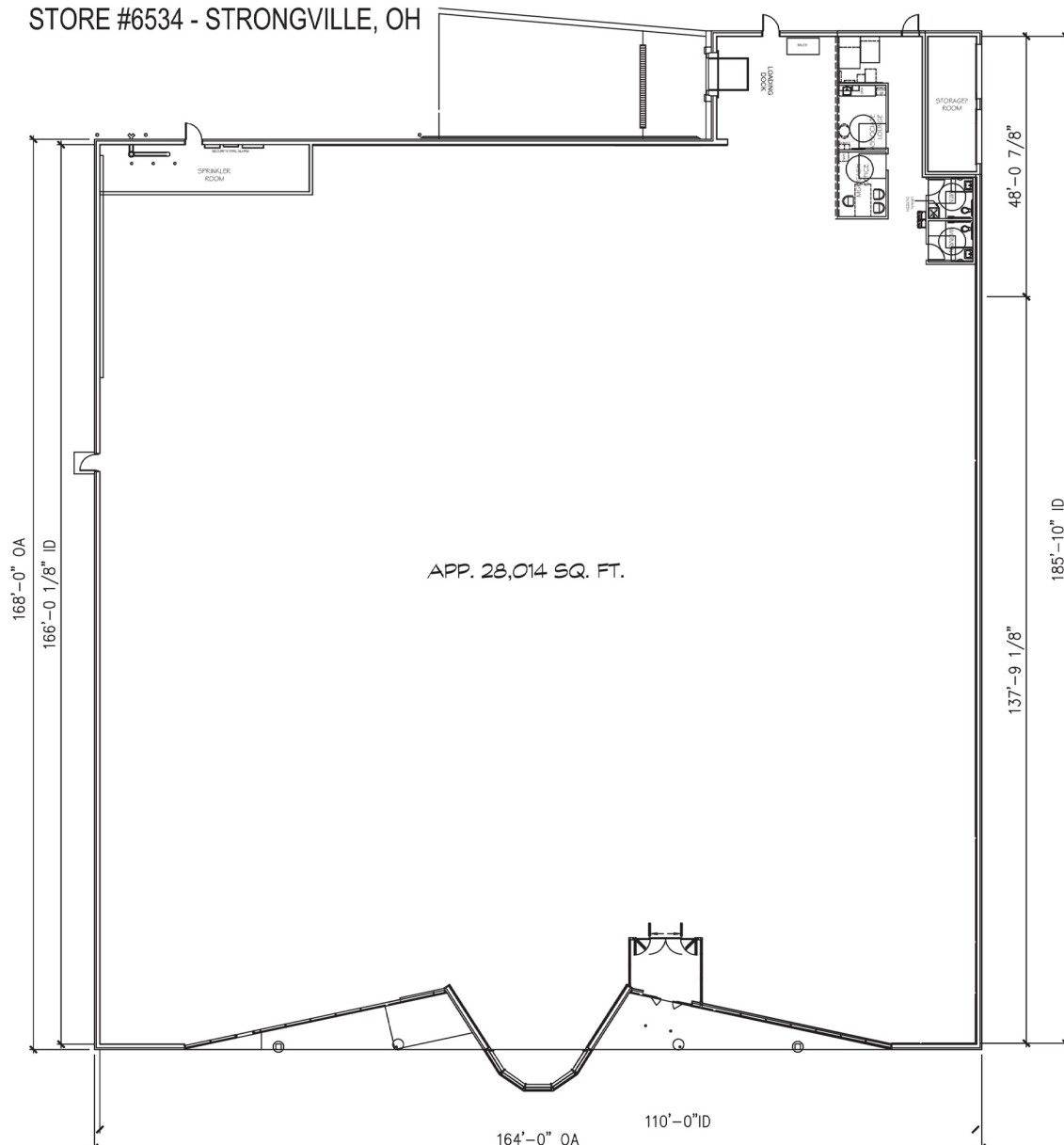

The information submitted herein is not guaranteed. Although obtained from reliable sources, it is subject to errors, omissions, prior sale and withdrawal from the market without notice. Broker has made no investigation and makes no representation of the property.

Tony Visconsi

216.861.5349

tonyvisconsi@hannacre.com

FOR LEASE

17171 Southpark Center

Strongsville, OH 44136

SUMMARY PROFILE

2000-2010 Census, 2021 Estimates with 2026 Projections

Calculated using Weighted Block Centroid from Block Groups

Lat/Lon: 41.3114/-81.819

17171 Southpark Center		1 mi radius	3 mi radius	5 mi radius
Strongsville, OH 44136				
POPULATION	2021 Estimated Population	4,658	54,512	138,228
	2026 Projected Population	4,683	55,412	139,593
	2010 Census Population	4,482	53,290	137,716
	2000 Census Population	4,443	51,144	133,987
	Projected Annual Growth 2021 to 2026	0.1%	0.3%	0.2%
	Historical Annual Growth 2000 to 2021	0.2%	0.3%	0.2%
HOUSEHOLDS	2021 Median Age	48.3	43.1	43.0
	2021 Estimated Households	2,131	22,350	56,793
	2026 Projected Households	2,170	22,993	58,108
	2010 Census Households	2,014	21,529	55,683
	2000 Census Households	1,862	19,278	51,152
	Projected Annual Growth 2021 to 2026	0.4%	0.6%	0.5%
RACE AND ETHNICITY	Historical Annual Growth 2000 to 2021	0.7%	0.8%	0.5%
	2021 Estimated White	86.3%	87.0%	89.6%
	2021 Estimated Black or African American	5.6%	4.3%	3.9%
	2021 Estimated Asian or Pacific Islander	4.7%	6.2%	4.0%
	2021 Estimated American Indian or Native Alaskan	-	-	0.2%
	2021 Estimated Other Races	3.4%	2.5%	2.4%
	2021 Estimated Hispanic	4.0%	3.2%	3.2%
	INCOME	2021 Estimated Average Household Income	\$88,688	\$109,110
2021 Estimated Median Household Income		\$68,903	\$85,068	\$76,717
2021 Estimated Per Capita Income		\$40,715	\$44,788	\$39,853
EDUCATION (AGE 25+)	2021 Estimated Elementary (Grade Level 0 to 8)	3.0%	1.7%	1.9%
	2021 Estimated Some High School (Grade Level 9 to 11)	1.3%	2.7%	3.6%
	2021 Estimated High School Graduate	25.9%	23.1%	26.8%
	2021 Estimated Some College	23.4%	19.3%	21.1%
	2021 Estimated Associates Degree Only	6.1%	7.3%	8.7%
	2021 Estimated Bachelors Degree Only	24.3%	28.3%	23.9%
BUSINESS	2021 Estimated Graduate Degree	16.1%	17.6%	13.9%
	2021 Estimated Total Businesses	480	1,938	4,611
	2021 Estimated Total Employees	5,999	24,765	58,669
	2021 Estimated Employee Population per Business	12.5	12.8	12.7
	2021 Estimated Residential Population per Business	9.7	28.1	30.0

This report was produced using data from private and government sources deemed to be reliable. The information herein is provided without representation or warranty.

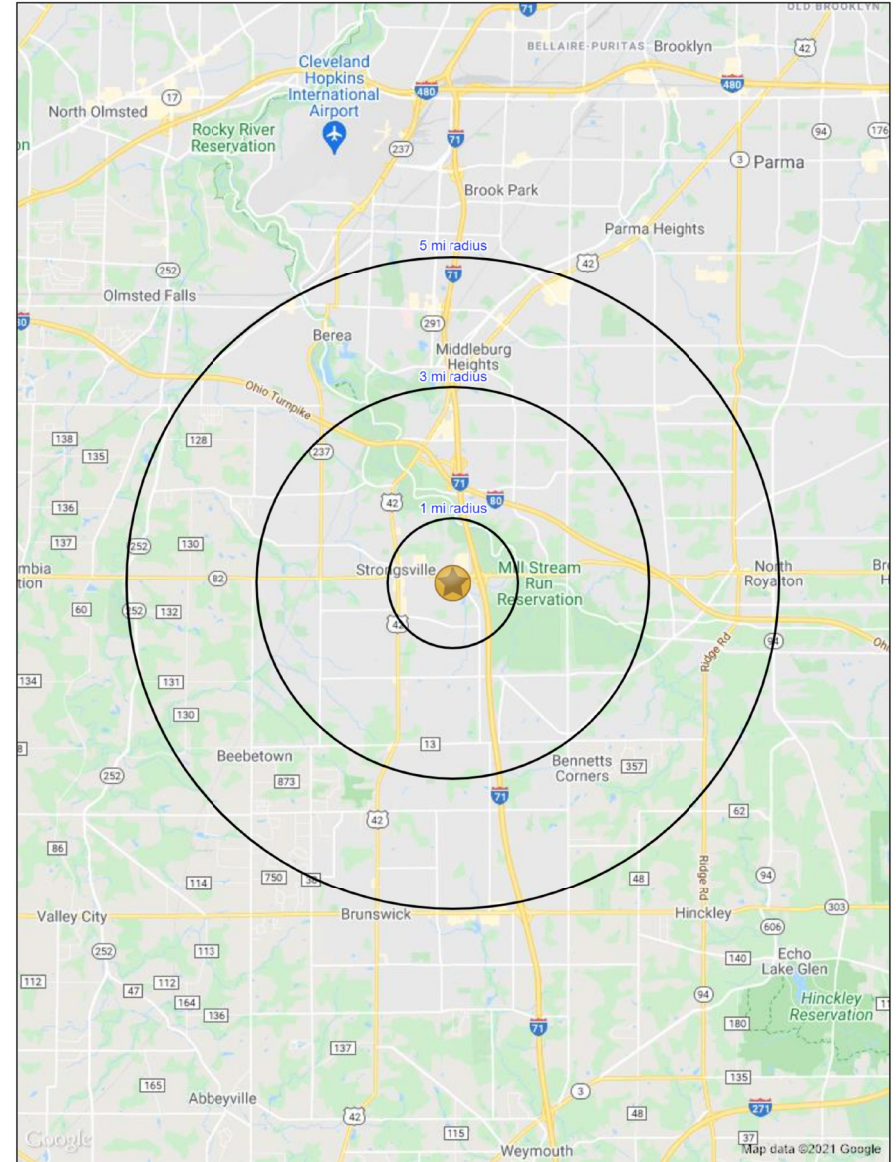

The information submitted herein is not guaranteed. Although obtained from reliable resources, it is subject to errors, omissions, prior sale and withdrawal from the market without notice. Broker has made no investigation and makes no representation of the property.

Tony Visconsi

216.861.5349

tonyvisconsi@hannacre.com