

# Brookview Shopping Center

Cleveland, Ohio



## Demographic Snapshot (2010 Census; 2015 Estimates)

	1-mile	3-miles	5-miles	10-mins
Population	16,236	108,785	298,811	412,054
Average HH Income	\$53,064	\$53,445	\$49,401	\$51,824
Median HH Income	\$53,064	\$53,445	\$40,014	\$41,532
Daytime Population	4,900	52,018	178,260	346,137
Households	7,433	48,003	129,124	178,918



- Conveniently located at the NW corner of Brookpark & Broadview Roads
- Three (3) inline spaces available for lease
  - Space #5 3,360 SF
  - Space #6 9,800 SF
  - Space #13B 1,600 SF
- Co-tenants include: US Bank, Best Cuts, Liberty Tax Service, and Mr. Hero
- Excellent traffic counts:
  - 23,000 VPD Brookpark Rd
  - 21,000 VPD Broadview Rd

**RANDY MARKOWITZ**

216.861.5262 | randymarkowitz@hannacre.com

28601 Chagrin Boulevard, Suite 250  
Cleveland, Ohio 44122-4541  
216.861.7200 | www.hannacre.com



*The information contained herein has been obtained from sources believed to be reliable. Hanna Commercial makes no guarantees, warranties, or representations as to the completeness or accuracy thereof. The presentation of this property is submitted subject to errors, omissions, change of price or condition, prior sale or lease, or withdrawal without notice. All information should be verified prior to purchase or lease.*

# Brookview Shopping Center

Cleveland, Ohio

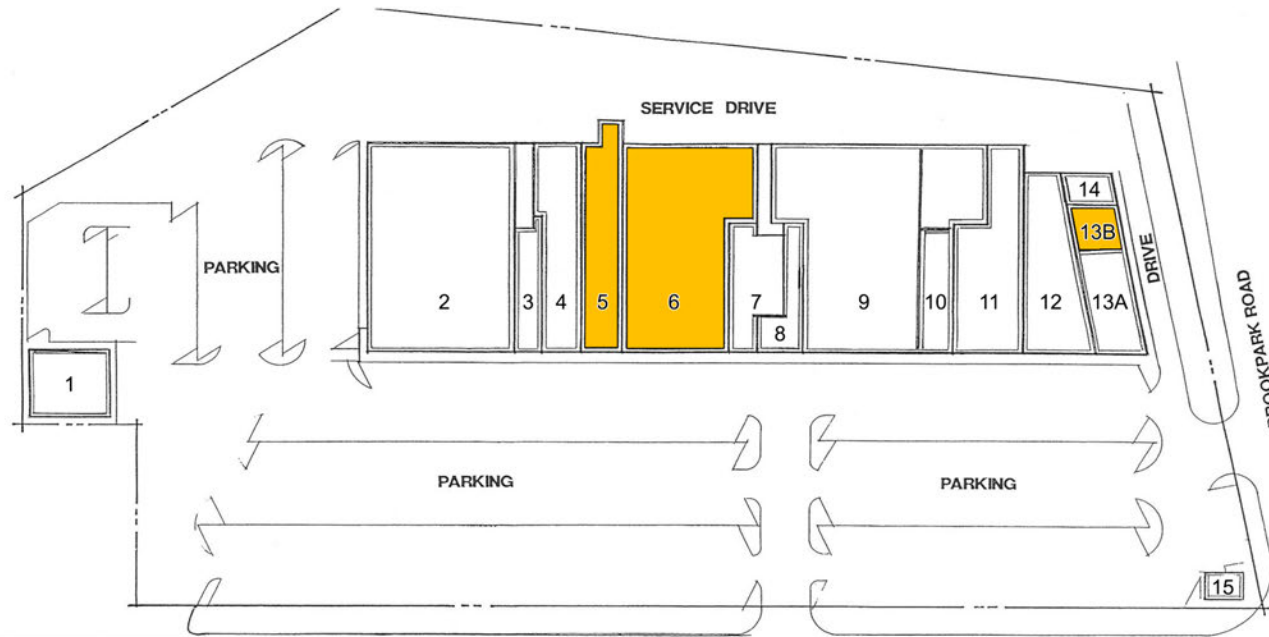

Tenant	Appx Size	Appx SF
1 Shaker's	47' x 53'	2,491
2 Save-A-Lot	117' x 140' *	16,380
3 CheckSmart	17' x 82' *	1,394
4 China Jade	20' x 140' *	2,800
5 AVAILABLE	24' x 140' *	3,360
6 AVAILABLE	70' x 140' *	9,800
7 Brookview Tavern & Eatery	28' x 85' *	2,394
8 Best Cuts	17' x 85' *	1,464
9 Family Dollar	87.5' x 140' *	12,237
10 Liberty Tax Service	21.5' x 82'	1,763
11 US Bank	37' x 140'	5,180
12 Mattress Factory Outlet	30' x 120' *	3,684
13A Mr. Hero	36' x 55' *	2,000
13B AVAILABLE	36' x 45' *	1,600
14 20th Century Barber	23' x 36' *	828
15 Charlie's Restaurant	outlot * irregular shape	
<b>TOTAL LEASABLE AREA</b>		<b>37,375 SF</b>
<b>TOTAL PARKING</b>		<b>322 CARS</b>

BROADVIEW ROAD

## Brookview Shopping Center Cleveland, Ohio

For Leasing Information:  
Randy Markowitz  
216.861.5262  
RandyMarkowitz@HannaCRE.com  
www.HannaCRE.com



**RANDY MARKOWITZ**  
216.861.5262 | randymarkowitz@hannacre.com

28601 Chagrin Boulevard, Suite 250  
Cleveland, Ohio 44122-4541  
216.861.7200 | www.hannacre.com



*The information contained herein has been obtained from sources believed to be reliable. Hanna Commercial makes no guarantees, warranties, or representations as to the completeness or accuracy thereof. The presentation of this property is submitted subject to errors, omissions, change of price or condition, prior sale or lease, or withdrawal without notice. All information should be verified prior to purchase or lease.*

# Brookview Shopping Center

Cleveland, Ohio

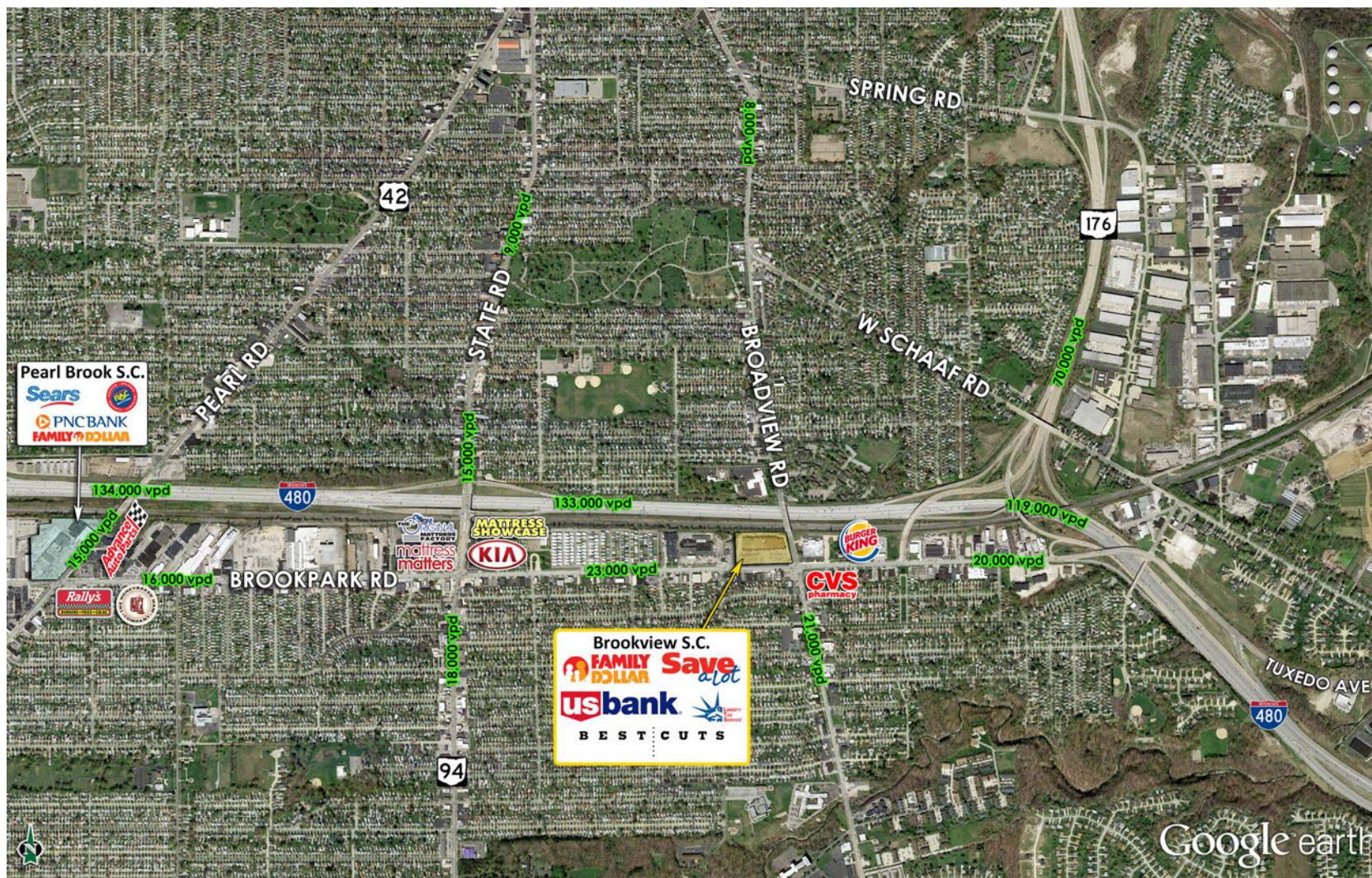

**RANDY MARKOWITZ**  
216.861.5262 | randymarkowitz@hannacre.com

28601 Chagrin Boulevard, Suite 250  
Cleveland, Ohio 44122-4541  
216.861.7200 | www.hannacre.com



*The information contained herein has been obtained from sources believed to be reliable. Hanna Commercial makes no guarantees, warranties, or representations as to the completeness or accuracy thereof. The presentation of this property is submitted subject to errors, omissions, change of price or condition, prior sale or lease, or withdrawal without notice. All information should be verified prior to purchase or lease.*