

FOR LEASE

12,254 SF Available - Great Northern Industrial Park
31382 - 31386 Lorain Rd., North Olmsted, OH



PROPERTY OVERVIEW

- 12,254 SF Total
- 2,814 SF Office
- 9,440 SF Warehouse
- 3 Docks
- 3 Drive-in Doors
- 17' Clear Height
- Building is zoned light industrial
- 208V / 100A / 3P power
- Masonry Construction
- Excellent Access to I-480 & I-80



[View in Google Maps](#)



The information submitted herein is not guaranteed. Although obtained from reliable resources, it is subject to errors, omissions, prior sale and withdrawal from the market without notice. Broker has made no investigation and makes no representation of the property.

Kevin Kuczynski

📞 216.861.5684

✉ KevinKuczynski@HannaCRE.com

FOR LEASE

12,254 SF Available - Great Northern Industrial Park 31382 - 31386 Lorain Rd., North Olmsted, OH

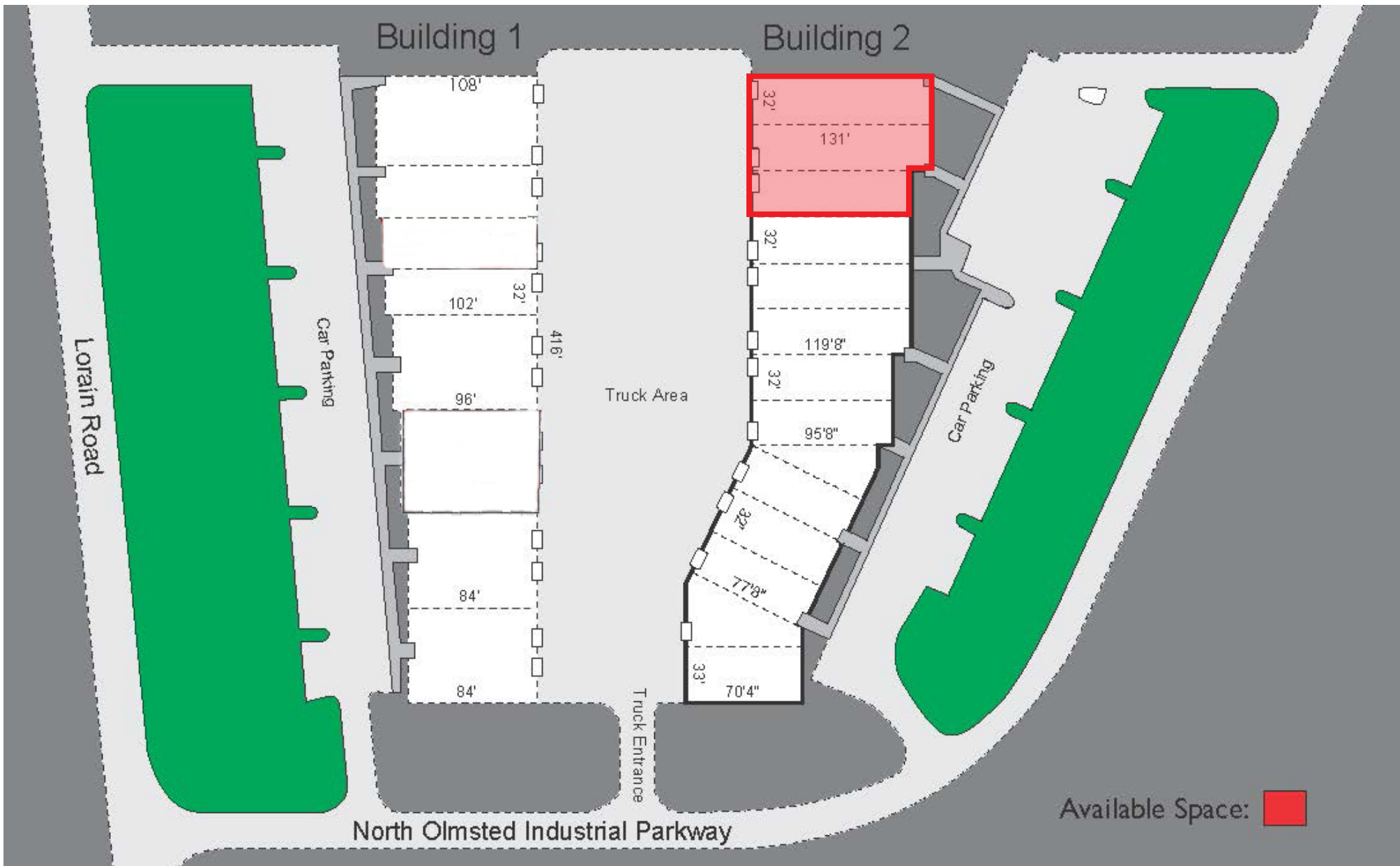

The information submitted herein is not guaranteed. Although obtained from reliable resources, it is subject to errors, omissions, prior sale and withdrawal from the market without notice. Broker has made no investigation and makes no representation of the property.

Kevin Kuczynski

216.861.5684

KevinKuczynski@HannaCRE.com